

22mm Push buttons and pilot devices

Metal series

Push-button operators



8 LM2T B104



8 LM2T B204



8 LM2T B302

Color	Qty per pkg	Catalog number
Flush (without mounting adapter), momentary.		
Black	10	8 LM2T B102
Green	10	8 LM2T B103
Red	10	8 LM2T B104
Yellow	10	8 LM2T B105
Blue	10	8 LM2T B106
White	10	8 LM2T B108
Extended (without mounting adapter), momentary.		
Black	10	8 LM2T B202
Green	10	8 LM2T B203
Red	10	8 LM2T B204
Yellow	10	8 LM2T B205
Blue	10	8 LM2T B206
White	10	8 LM2T B208
Guarded (without mounting adapter), momentary.		
Black	10	8 LM2T B302
Green	10	8 LM2T B303
Red	10	8 LM2T B304
Yellow	10	8 LM2T B305
Blue	10	8 LM2T B306
White	10	8 LM2T B308

Push-button operators with inscription



8 LM2T B1104



8 LM2T B2104

Inscription	Color	Qty per pkg	Catalog number
Flush (without mounting adapter), momentary.			
O	Black	10	8 LM2T B1102
	Red	10	8 LM2T B1104
I	Green	10	8 LM2T B1113
	White	10	8 LM2T B1118
II	Green	10	8 LM2T B1123
	White	10	8 LM2T B1128
STOP	Black	10	8 LM2T B1132
	Red	10	8 LM2T B1134
← ①	Black	10	8 LM2T B1142
	White	10	8 LM2T B1148
↑ ②	Black	10	8 LM2T B1152
	White	10	8 LM2T B1158
START	Green	10	8 LM2T B1163
	White	10	8 LM2T B1168
R	Blue	10	8 LM2T B1176
	White	10	8 LM2T B1178
RESET	Blue	10	8 LM2T B1196
	Black	10	8 LM2T B1502
↔	Black	10	8 LM2T B1512
Extended (without mounting adapter), momentary.			
O	Black	10	8 LM2T B2102
	Red	10	8 LM2T B2104
STOP	Black	10	8 LM2T B2132
	Red	10	8 LM2T B2134

① Arrow inscription can be used to indicate right or left.
 ② Arrow inscription can be used to indicate up or down.

Operational characteristics

- Ambient operating temperature: -10 to +140°F (-25 to +60°C)
- Ambient storage temperature: -40 to +160°F (-40 to +70°C)
- Any mounting position is allowed
- Degree of protection: IP65.

Reference standards

Compliant with standards: IEC/EN 60947-1, IEC/EN 60947-5-1.

Materials

An aluminium and zinc alloy (zama) is used for the metal part whereas plastic parts are made of polyamide and polycarbonate.

Mechanical endurance

Operating force: 1.76lb / 0.8kg (operator).
 Mechanical life: 1,000,000 cycles.

Mounting adapter

See page 4-13.
 Catalog number: 8 LM2T AU120.
 Operators latch onto the mounting adapter with a simple rotation.
 The adapter is fixed to the mounting surface by means of incorporated screws (Tmax = 7.1in lb / 0.8 Nm).

Auxiliary contacts

See page 6-17.
 Catalog numbers: 8 LM2T C10 (1NO)
 8 LM2T CF10 (1NO Faston)
 8 LM2T C10A (EM)
 8 LM2T C01 (1NC)
 8 LM2T CF01 (1NC Faston)
 8 LM2T C01D (LB)

Auxiliary contacts snap onto the mounting adapter. Up to 6 auxiliary contacts can be fitted on the mounting adapter: 2 on the left, 2 at the center and 2 on the right. To mount the auxiliary contacts in the center position, use the accessory: LM2T A140 (see page 6-21).

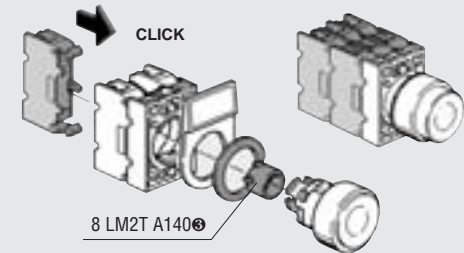

Ⓢ The action plug LM2T A140 for the center position is not standard supplied and must be purchased separately.

To locate additional product specifications and technical drawings go to www.asi-ez.com