

# 22mm Push buttons and pilot devices

## Metal series

### Illuminated button operators



8 LM2T BL104



8 LM2T BL204

Color	Qty per pkg	Catalog number
<b>Flush (with side visibility), momentary (without mounting adapter).</b>		
Green	10	8 LM2T BL103
Red	10	8 LM2T BL104
Yellow	10	8 LM2T BL105
Blue	10	8 LM2T BL106
Transparent	10	8 LM2T BL107
<b>Extended (without mounting adapter), momentary.</b>		
Green	10	8 LM2T BL203
Red	10	8 LM2T BL204
Yellow	10	8 LM2T BL205
Blue	10	8 LM2T BL206
Transparent	10	8 LM2T BL207

### Push-push button operators



8 LM2T QL10...



8 LM2T QL20...

Color	Qty per pkg	Catalog number
<b>Flush (without mounting adapter). Maintained, push to release.</b>		
Green	10	8 LM2T QL103
Red	10	8 LM2T QL104
Yellow	10	8 LM2T QL105
Blue	10	8 LM2T QL106
Transparent	10	8 LM2T QL107
<b>Extended (without mounting adapter). Maintained, push to release.</b>		
Green	10	8 LM2T QL203
Red	10	8 LM2T QL204
Yellow	10	8 LM2T QL205
Blue	10	8 LM2T QL206
Transparent	10	8 LM2T QL207

① Use only the early-make type, 8 LM2T C10A.  
No normally open contact element, 8 LM2T C10, must be used with this type of button actuators.  
A maximum of 2 contact elements can be mounted only.

### Illuminated mushroom head button operators



8 LM2T BL6144



8 LM2T BL6245

Color	Qty per pkg	Catalog number	Price \$
<b>Momentary. Ø 40 mm (1.6in) (without mounting adapter).</b>			
Green	10	8 LM2T BL6143	
Red	10	8 LM2T BL6144	
Yellow	10	8 LM2T BL6145	
Blue	10	8 LM2T BL6146	
White	10	8 LM2T BL6148	
<b>Maintained, pull to release. Ø 40mm (1.6in) (without mounting adapter).</b>			
Green	10	8 LM2T BL6243	
Red	10	8 LM2T BL6244	
Yellow	10	8 LM2T BL6245	
Blue	10	8 LM2T BL6246	
White	10	8 LM2T BL6248	

#### Operational characteristics

- Ambient operating temperature: -10 to +140°F (-25 to +60°C)
- Ambient storage temperature: -40 to +160°F (-40 to +70°C)
- Any mounting position is allowed
- Degree of protection: IP65.

#### Reference standards

Compliant with standards: IEC/EN 60947-1, IEC/EN 60947-5-1.

#### Materials

An aluminium and zinc alloy (zama) is used for the metal part whereas plastic parts are made of polyamide and polycarbonate.

#### Mechanical endurance

Operating force: 1.76lb / 0.8kg (operator).  
Mechanical life for push-push operators: 500,000 cycles.  
Mechanical life for others: 1,000,000 cycles.

#### Mounting adapter

See page 6-17.  
Catalog number: 8 LM2T AU120.  
Operators latch onto the mounting adapter with a simple rotation.

The adapter is fixed to the mounting surface by means of incorporated screws (Tmax = 7.14in lb / 0.8 Nm).

#### Auxiliary contacts for push-push operators:

See page 6-17. Auxiliary contacts snap on to the mounting adapter.

Catalog number: 8 LM2T C10A (EM)  
8 LM2T C01 (1NC)

Up to 2 auxiliary contacts can be fitted on the mounting adapter in a row, 1 each on the right and left, along with the lamp-holder in the center position, of which LM2T DL400, LM2T EL400, LM2T VL230, LM2T ZL230, LM2T L or LM2T M (see page 6-18).

With lamp-holder LM2T XL, LM2T YL, LM2T FL or LM2T GL, one auxiliary contact can be mounted only (see page 6-18).

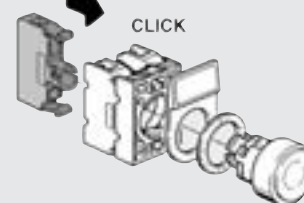

#### Auxiliary contacts for button or mushroom-head operators:

See page 6-17. Auxiliary contacts snap on to the mounting adapter.

Catalog numbers: 8 LM2T C10 (1NO)  
8 LM2T CF10 (1NO Faston)  
8 LM2T C10A (EM)  
8 LM2T C01 (1NC)  
8 LM2T CF01 (1NC Faston)  
8 LM2T C01D (LB)

- Up to 4 auxiliary contacts can be fitted on the mounting adapter, 2 each on the right and left sides, when one of the following types of lamp-holders are used: LM2T DL400, LM2T EL400, LM2T VL230, LM2T ZL230, LM2T L or LM2T M (see page 6-18).

- Up to 2 auxiliary contacts can be fitted on the mounting adapter, one on top of the other of the same type only, when the following types of lamp-holders are used: LM2T L, LM2T M, LM2T YL, LM2T FL or LM2T GL (see page 6-18).

- Up to 2 auxiliary contacts only can be fitted with the actuator type LM2T BL624 whichever lamp-holder type is used.

#### Lamp-holder elements

See pages 6-18.

#### Bulbs

Maximum recommended power for push-buttons and selectors: 1.2W. See page 6-20.

To locate additional product specifications and technical drawings go to [www.asi-ez.com](http://www.asi-ez.com)