

22mm Push buttons and pilot devices

Metal series

Selector switch operators, key



8 LM2T S3

Type of positions	Qty per pkg	Catalog number
2 position (without mounting adapter).		
	10	8 LM2T S320
	1	8 LM2T S320G... ^①
	10	8 LM2T S321
	1	8 LM2T S321G... ^①
	10	8 LM2T S340
	1	8 LM2T S340G... ^①
3 position (without mounting adapter).		
	10	8 LM2T S330
	1	8 LM2T S330G... ^①
	10	8 LM2T S331
	1	8 LM2T S331G... ^①
	10	8 LM2T S332 ^②
	1	8 LM2T S332G... ^{①②}
	10	8 LM2T S333 ^②
	1	8 LM2T S333G... ^{①②}
	10	8 LM2T S350
	1	8 LM2T S350G... ^①
	10	8 LM2T S360
	1	8 LM2T S360G... ^①
	10	8 LM2T S370 ^②
	1	8 LM2T S370G... ^{①②}
	10	8 LM2T S380 ^②
	1	8 LM2T S380G... ^{①②}
	10	8 LM2T S390 ^②
	1	8 LM2T S390G... ^{①②}

- ^① Versions with different key codes.
Complete with the numeric code of the key. The following versions are available: 501, 502, 503, 504, 505, 506, 507, 508, 509, 510.
Example of complete code: 8 LM2T S320G505.
- ^② Available only on specific request.

Operational characteristics

- Ambient operating temperature: -10 to +140°F (-25 to +60°C)
- Ambient storage temperature: -40 to +160°F (-40 to +70°C)
- Any mounting position is allowed
- Degree of protection: IP65.

Reference standards

Compliant with standards: IEC/EN 60947-1, IEC/EN 60947-5-1.

Materials

An aluminium and zinc alloy (zama) is used for the metal part whereas plastic parts are made of polyamide and polycarbonate.

Mechanical endurance

Mechanical life for selector operators: 300,000 cycles.

Mounting adapter

See page 6-17.

Catalog number: 8 LM2T AU120.

Operators latch onto the mounting adapter with a simple rotation.

The adapter is fixed to the mounting surface by means of incorporated screws (Tmax = 7.1 in lb / 0.8 Nm).

Auxiliary contacts for selector operators

See page 6-17.

Catalog numbers: 8 LM2T C10 (1NO)
8 LM2T CF10 (1NO Faston)
8 LM2T C10A (EM)
8 LM2T C01 (1NC)
8 LM2T CF01 (1NC Faston)
8 LM2T C01D (LB)

Auxiliary contacts snap onto the mounting adapter.

Up to 6 auxiliary contacts can be fitted on the mounting adapter: 3 on the left and 3 on the right.

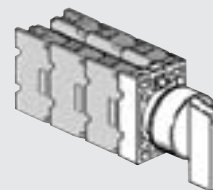

Positions

- Maintained position.
- Spring return position.
- Key withdrawal position.

Angles

2 position



3 position



Special versions

Versions with coloured keys are available upon request.
Contact Sales & Technical Support.

To locate additional product specifications and technical drawings go to www.asi-ez.com