

22mm Push buttons and pilot devices

Plastic series

Two button momentary operators



8 LP2T B7113



8 LP2T B7223

Colors	Marked in white	Qty per pkg	Catalog number
Two flush push-buttons (complete with mounting adapter).			
Black/Red	—	10	8 LP2T B7112
Green/Red	—	10	8 LP2T B7113
White/Black	—	10	8 LP2T B7114
Black/Red	I-O	10	8 LP2T B7122
Green/Red	I-O	10	8 LP2T B7123
White/Black	I-O	10	8 LP2T B7124
Green/Red	Start/Stop	10	8 LP2T B7133
One extended and one flush button (c/w mounting adapter).			
Black/Red	—	10	8 LP2T B7212
Green/Red	—	10	8 LP2T B7213
White/Black	—	10	8 LP2T B7214
Black/Red	I-O	10	8 LP2T B7222
Green/Red	I-O	10	8 LP2T B7223
White/Black	I-O	10	8 LP2T B7224
Green/Red	Start/Stop	10	8 LP2T B7233

Three button momentary operators



8 LP2T B7355

Colors	Marked in white	Qty per pkg	Catalog number
Two external flush and one middle extended buttons. Complete with mounting adapter.			
Green Red Green	 STOP 	10	8 LP2T B7345
Green Red Green	↑ STOP ↓	10	8 LP2T B7355
Green Red Green	→ STOP ←	10	8 LP2T B7365
Green Red Green	↗ STOP ↖	10	8 LP2T B7375

Operational characteristics

- Ambient operating temperature: -10 to +140°F (-25 to +60°C)
- Ambient storage temperature: -40 to +160°F (-40 to +70°C)
- Any mounting position is allowed.
- Degree of protection: IP66 (IP65 for LP2T B654 and IP40 for two button operators).

Reference standards

Compliant with standards: IEC/EN 60947-1, IEC/EN 60947-5-1.

Materials

Polyamide and polycarbonate.

Mechanical endurance

Operating force: 1.76lb / 0.8 kg (operator).
 Mechanical life for mushroom-head and double touch push buttons: 1,000,000 cycles.
 Mechanical life for mushroom-head latch push reset buttons: 300,000 cycles.

Mounting adapter

Standard supply with the operator.
 Operators latch onto the mounting adapter with a simple rotation.

The adapter is fixed to the mounting surface by means of incorporated screws (Tmax = 5.3in lb / 0.6 Nm).

Auxiliary contacts

See page 6-17.

Auxiliary contacts snap onto the mounting adapter

- Catalog numbers:
- 8 LM2T C10 (1NO)
 - 8 LM2T CF10 (1NO Faston)
 - 8 LM2T C10A (EM)
 - 8 LM2T C01 (1NC)
 - 8 LM2T CF01 (1NC Faston)
 - 8 LM2T C01D (LB)

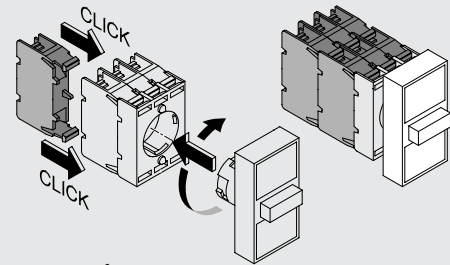

TWO BUTTON OPERATORS

Up to 4 auxiliary contacts can be fitted on the mounting adapter: 2 on the left and 2 on the right.

THREE BUTTON OPERATORS

Up to 6 auxiliary contacts can be fitted on the mounting adapter: 2 on the left, 2 in the center and 2 on the right.

To locate additional product specifications and technical drawings go to www.asi-ez.com