

22mm Push buttons and pilot devices

Plastic series

Selector switch operators, knob



8 LP2T S1

Type of positions	Qty per pkg	Catalog number
2 position (complete with mounting adapter).		
∨	10	8 LP2T S120
∨	10	8 LP2T S121
3 position (complete with mounting adapter).		
∨	10	8 LP2T S130
∨	10	8 LP2T S131
∨	10	8 LP2T S132
∨	10	8 LP2T S133

Selector switch operators, lever



8 LP2T S2

Type of positions	Qty per pkg	Catalog number
2 position (complete with mounting adapter).		
∨	10	8 LP2T S220
∨	10	8 LP2T S221
3 position (complete with mounting adapter).		
∨	10	8 LP2T S230
∨	10	8 LP2T S231
∨	10	8 LP2T S232
∨	10	8 LP2T S233

Selector switch operators, key



8 LP2T S3

Type of positions	Qty per pkg	Catalog number
2 position (complete with mounting adapter).		
∨	10	8 LP2T S320
∨	1	8 LP2T S320G...①
∨	10	8 LP2T S321
∨	1	8 LP2T S321G...①
∨	10	8 LP2T S340
∨	1	8 LP2T S340G...①
3 position (complete with mounting adapter).		
∨	10	8 LP2T S330
∨	1	8 LP2T S330G...①
∨	10	8 LP2T S331
∨	1	8 LP2T S331G...①
∨	10	8 LP2T S332②
∨	1	8 LP2T S332G...①②
∨	10	8 LP2T S333②
∨	1	8 LP2T S333G...①②
∨	10	8 LP2T S350
∨	1	8 LP2T S350G...①
∨	10	8 LP2T S360
∨	1	8 LP2T S360G...①
∨	10	8 LP2T S370②
∨	1	8 LP2T S370G...①②
∨	10	8 LP2T S380②
∨	1	8 LP2T S380G...①②
∨	10	8 LP2T S390②
∨	1	8 LP2T S390G...①②

① Versions with different key codes. Complete with the numeric code of the key. The following versions are available: 501, 502, 503, 504, 505, 506, 507, 508, 509, 510. Example of complete catalog number: 8 LP2T S320G505.

② Available only on specific request.

Operational characteristics

- Ambient operating temperature: -10 to +140°F (-25 to +60°C)
- Ambient storage temperature: -40 to +160°F (-40 to +70°C)
- Any mounting position is allowed
- Degree of protection: IP65.

Reference standards

Compliant with standards: IEC/EN 60947-1, IEC/EN 60947-5-1.

Materials

Polyamide and polycarbonate.

Mechanical endurance

Mechanical life: 300,000 cycles.

Mounting adapter

Standard supply with the operator. Operators latch onto the mounting adapter with a simple rotation.

The adapter is fixed to the mounting surface by means of incorporated screws (Tmax = 5.3in lb / 0.6 Nm).

Auxiliary contacts

See page 6-17.

Auxiliary contacts snap onto the mounting adapter.

Catalog numbers: 8 LM2T C10 (1NO)
8 LM2T CF10 (1NO Faston)
8 LM2T C10A (EM)
8 LM2T C01 (1NC)
8 LM2T CF01 (1NC Faston)
8 LM2T C01D (LB)

Up to 6 auxiliary contacts can be fitted on the mounting adapter: 3 on the left and 3 on the right.

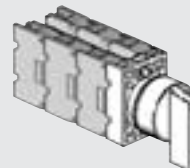

Positions

- ∨ Maintained position.
- ∨ Spring return position.
- ∨ Key withdrawal position.

Angles

2 position



3 position



Special versions

Versions with colored keys are available upon request. Contact Sales & Technical Support.

To locate additional product specifications and technical drawings go to www.asi-ez.com