

Push-push button actuators



LPC Q10...

new



LPC Q20...

new

Order code	Colour	Qty per pkg	Wt
		n°	[kg]

Flush (without mounting adapter).
Push on-push off.

LPC Q102	Black	10	0.025
LPC Q103	Green	10	0.025
LPC Q104	Red	10	0.025
LPC Q105	Yellow	1	0.025
LPC Q106	Blue	1	0.025
LPC Q108	White	1	0.025

Extended (without mounting adapter).
Push on-push off.

LPC Q202	Black	10	0.027
LPC Q203	Green	10	0.027
LPC Q204	Red	10	0.027
LPC Q205	Yellow	1	0.027
LPC Q206	Blue	1	0.027
LPC Q208	White	1	0.027

ⓘ Contact elements LPX C10 (NO) and LPX C01D (LB) cannot be fitted on these actuators.
Use contact elements LPX C10A (EM) and LPXC01 (NC) only.

Mushroom head push button actuators



LPC B614...

new



LPC B616...

new



LPC B674...

new



LPC B6634

new



LPC B6644

new



LPC B684...

new

Order code	Colour	Qty per pkg	Wt
		n°	[kg]

SPRING RETURN.
Ø40mm/1.6in (without mounting adapter).

LPC B6142	Black	10	0.033
LPC B6143	Green	10	0.033
LPC B6144	Red	10	0.033
LPC B6145	Yellow	10	0.033
LPC B6146	Blue	10	0.033

SPRING RETURN.
Ø60mm/2.4in (without mounting adapter).

LPC B6162	Black	10	0.038
LPC B6163	Green	10	0.038
LPC B6164	Red	10	0.038
LPC B6165	Yellow	10	0.038
LPC B6166	Blue	10	0.038

LATCH, PULL TO RELEASE
Ø40mm/1.6in (without mounting adapter).
For normal stopping.

LPC B6742	Black	10	0.097
LPC B6744	Red	10	0.097

LATCH, TURN TO RELEASE
Ø40mm/1.6in (without mounting adapter).
For normal stopping.

LPC B6342	Black	10	0.046
LPC B6344	Red	10	0.046

Ø30mm/1.2in (without mounting adapter).
For emergency stopping, ISO 13850 compliant.

LPC B6634	Red	10	0.079
-----------	-----	----	-------

Ø40mm/1.6in (without mounting adapter).
For emergency stopping, ISO 13850 compliant.

LPC B6644	Red	10	0.079
-----------	-----	----	-------

LATCH, TURN KEY TO RELEASE
Ø40mm/1.6in (without mounting adapter).
For normal stopping.

LPC B6842	Black	10	0.083
LPC B6842R	Black	1	0.083

For emergency stopping, ISO 13850 compliant.

LPC B6844	Red	10	0.083
LPC B6844R	Red	1	0.083

ⓘ Versions with different key codes.
Complete with the numeric code of the key.
The following versions are available: 421E, 458A, 520E, 3131A, 3433E.
Example of complete code: LPC B6844R 421E.

Operational characteristics

- Ambient conditions:
 - Operating temperature: -25...+70°C
 - Storage temperature: -40...+85°C
- Any mounting position is allowed.
- Degree of protection:
 - Per IEC/EN: IP66, IP67 and IP69K
 - Per UL: type 1, 2, 3R, 4, 4X, 12, 12K.

Materials

Polyamide.

Mechanical endurance

- Operating force: <0.5kg / 1.1lb (actuator).
Mechanical life:
- Push-push actuators: 500,000 cycles;
 - Mushroom head buttons: 5,000,000 cycles;
 - Mushroom head latch buttons: 300,000 cycles.

Mounting adapter

See page 7-12.
Type: LPX AU120.
Actuators are installed through a Ø22mm/Ø0.87in drilling with a threaded fixing ring (Tmax = 2.3Nm / 1.69lbf).
The mounting adapter directly snaps onto the actuator.

Contact elements for push-push button actuators

See page 7-12.
Type: LPX C10A (1EM)
LPX C01 (1NC)

Contact elements snap onto the mounting adapter.
Up to 6 contact elements can be fitted on the mounting adapter: 2 on the left, 2 at the centre and 2 on the right.

Contact elements for mushroom head spring return button actuators

See page 7-12.
Type: LPX C10 (1NO)
LPX CF10 (1NO Faston)
LPX C10A (1EM)
LPX C01 (1NC)
LPX CF01 (1NC Faston)
LPX C01D (1LB)

Contact elements snap onto the mounting adapter.
Up to 9 auxiliary contacts can be fitted on the mounting adapter: 3 on the left, 3 at the centre and 3 on the right.
To mount the contact elements in the centre position, use the accessory: LPX A140; see page 7-17.

Contact elements for mushroom head latch button actuators

See page 7-12.
Type: LPX C10 (1NO)
LPX CF10 (1NO Faston)
LPX C10A (1EM)
LPX C01 (1NC)
LPX CF01 (1NC Faston)
LPX C01D (1LB)

Contact elements snap onto the mounting adapter.
Up to 6 contact elements can be fitted on the mounting adapter: 2 on the left, 2 at the centre and 2 on the right.

Certifications and compliance

Certifications obtained: UL Listed, for USA and Canada (File E93601), as Auxiliary Devices.
Certifications pending at time of catalogue printing: CCC.
Compliant with standards: IEC/EN 60947-1, IEC/EN 60947-5-1, UL508, CSA C22.2 n° 14.

Mounting adapter



LPX AU120



Order code	Description	Qty per pkg	Wt
		n°	[kg]
LPX AU120	Mounting adapter	10	0.019

Contact elements

7-12



LPX C...



Order code	Function	Qty per pkg	Wt
	All SPST	n°	[kg]

Screw termination.
 Without mounting adapter.

LPX C10Ⓢ	$\begin{matrix} 1.3 \\ \\ 1.4 \end{matrix}$ NOⓈ	10	0.011
LPX C10A	$\begin{matrix} 1.7 \\ \\ 1.8 \end{matrix}$ EMⓈ	10	0.011
LPX C01⊖	$\begin{matrix} 1.1 \\ \\ 1.2 \end{matrix}$ NCⓈ	10	0.011
LPX C01DⓈ⊖	$\begin{matrix} 1.5 \\ \\ 1.6 \end{matrix}$ LBⓈⓈ	10	0.011

Screw termination.
 With mounting adapter.

LPX E10Ⓢ	$\begin{matrix} 1.3 \\ \\ 1.4 \end{matrix}$ NOⓈ	10	0.029
LPX E01⊖	$\begin{matrix} 1.1 \\ \\ 1.2 \end{matrix}$ NCⓈ	10	0.029

Faston termination.
 Without mounting adapter.

LPX CF10Ⓢ	$\begin{matrix} 1.3 \\ \\ 1.4 \end{matrix}$ NOⓈ	10	0.012
LPX CF01⊖	$\begin{matrix} 1.1 \\ \\ 1.2 \end{matrix}$ NCⓈ	10	0.012

- Ⓢ Not suitable for push-push actuators. Use LPX C10A (EM) or LPX C01 (NC) type only with push-push actuators.
- Ⓢ Normally open contact with early make operation.
- ⊖ Direct opening operation ⊖ in accordance with IEC/EN 60947-5-1.
- Ⓢ Normally closed contact with late break operation.



LPX E...



LPX CF01 LPX CF10



Operational characteristics

- Ambient conditions:
 - Operating temperature: -25...+70°C
 - Storage temperature: -40...+85°C
- Any mounting position is allowed.
- Degree of protection per IEC/EN:
 - IP20 for contacts elements with screw termination
 - IP00 for contact elements with Faston termination.
- Tightening torque: 1Nm/0.74lbf max (except Faston).

General characteristics of contact elements

Self cleaning, dual scraping-oscillating action
 IEC rated insulation voltage: 690V
 IEC rated thermal current Ith: 10A
 Conductivity: 5V 1mA
 UL/CSA and IEC/EN 60947-5-1 designation: A600 Q600.
 IEC operational power in AC15:

[V]	12	24	48	120	240	400	480	500	600
[A]	6	6	6	6	3	1.9	1.5	1.4	1.2

IEC operational power in DC13:

[V]	12	24	48	125	250	440	500	600
[A]	3	3	1.5	0.55	0.27	0.15	0.13	0.1

Short-circuit protection fuse: max calibre 10A gG/SC.

Contact resistance: ≤20mΩ.

Terminals: Clamp screw with washer
 Faston 1-6.35mm(0.25in) or 2-2.8mm (0.11in).

Stroke of contact elements

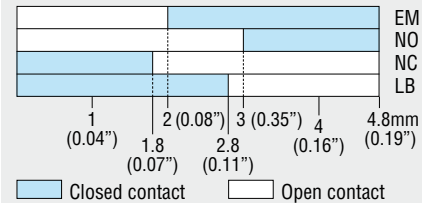

Maximum conductor cross section for screw terminals
 1 or 2 2.5mm² or AWG14 cables.

Mechanical and electrical endurance

Operating force: ≤0.5kg / 1.1lb (auxiliary contacts).
 Electrical life:

LPX C10	1,000,000 cycles
LPX CF10	1,000,000 cycles
LPX C01	1,000,000 cycles
LPX CF01	1,000,000 cycles
LPX C10A	600,000 cycles
LPX C01D	600,000 cycles.

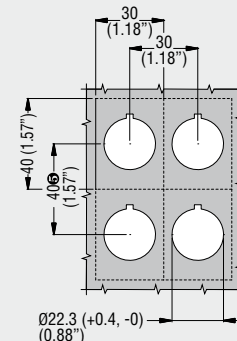

Ⓢ When using Faston, pitch is 85mm / 3.35in minimum.

Certifications and compliance

Certifications obtained: UL Listed, for USA and Canada (File E93601), as Auxiliary Devices.
 Certifications pending at time of catalogue printing: CCC.
 Compliant with standards: IEC/EN 60947-1, IEC/EN 60947-5-1, UL508, CSA C22.2 n° 14.

Pushbuttons and selector switches

PLatinum Ø22mm series

Accessories and spare parts



LPX A140



LPX B104



LPX B203



LPX BL105



LPX BL206

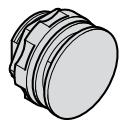

8 LM2T A130

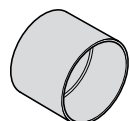

8 LM2T A185

Order code	Description	Qty per pkg	Wt
		n°	[kg]
LPX A127	Transparent diffuser for double-touch buttons	10	0.001
LPX A140	Action plug for centre contact	50	0.001
LPX A150	Rod for mechanical reset button (l=150mm/5.91in)	10	0.006
LPX A170	Spare standard key set for selector switches or mushroom-head buttons	10	0.008
LPX A170R ^①	Spare key set for selector switches or mushroom head buttons, LPC.. R type	1	0.008

Flush cap for spring-return actuators.

LPX B102	Black	10	0.002
LPX B103	Green	10	0.002
LPX B104	Red	10	0.002
LPX B105	Yellow	10	0.002
LPX B106	Blue	10	0.002
LPX B108	White	10	0.002

Extended cap for spring-return actuators.

LPX B202	Black	10	0.003
LPX B203	Green	10	0.003
LPX B204	Red	10	0.003
LPX B205	Yellow	10	0.003
LPX B206	Blue	10	0.003
LPX B208	White	10	0.003

Flush lens for illuminated spring-return actuators.

LPX BL103	Green	10	0.002
LPX BL104	Red	10	0.002
LPX BL105	Yellow	10	0.002
LPX BL106	Blue	10	0.002
LPX BL108	White	10	0.002

Extended lens for illuminated spring-return actuators.

LPX BL203	Green	10	0.003
LPX BL204	Red	10	0.003
LPX BL205	Yellow	10	0.003
LPX BL206	Blue	10	0.003
LPX BL208	White	10	0.003

^① Versions with different key code. Complete with the numeric code of the key. The following versions are available: 421E, 458A, 520E, 3131A, 3433E. Example of complete code: LPX A170R421E.

Order code	Description	Qty per pkg	Wt
		n°	[kg]
8 LM2T A130	Threaded plug for unused drilled holes	10	0.007
8 LM2T A161	Ø30mm/1.2in hole size adapter set for 22mm/0.87in (use 2 per hole)	10	0.002
8 LM2T A185	Selector protection shroud for knob type only	10	0.004
8 LM2T A200	Socket spanner/wrench for fixing ring fitting	1	0.184