

**CZM CZM..SQ\***

Interlocking modules - Modulo componibile  
Elements modulaires - Zusammensteckbare Blöcke

Poles - Poli - Pôles - Polzahl 2/3



Pitch / Pas	5
Rated Voltage / Tensione nominale	200
Rated Current / Corrente nominale	13,5

Types of cables / Tipo cavi	0,5 ÷ 1,5 / 30 ÷ 14	0,5 ÷ 1 / 30 ÷ 14	0,5 ÷ 1 / 30 ÷ 14
Nominal cross section / Sezione nominale	mm AWG	mm AWG	mm AWG
Stripping length / Lunghezza spelatura	6	6	6
Torque / Coppia di torsione	0,4	/	3
Temperature / Temperatura	85	85	85
Housing / Corpo isolante	PC - UL 94 V0		
Screw / Vite	M2,5		
Dimensions	0,6 x 3,5		

V	A	mm / AWG
250	13,5	0,5 ÷ 1
250	13,5	0,5 ÷ 1
300	14	26 ÷ 14

min 2 - max...		
GR	/ on demand	NE
D/A2		

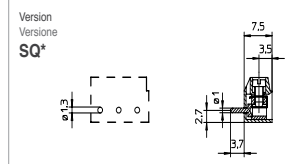
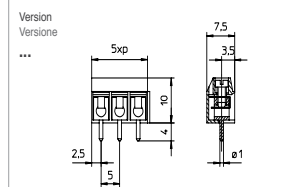

**CZM CZM..SQ\***

Interlocking modules - Modulo componibile  
Elements modulaires - Zusammensteckbare Blöcke

Poles - Poli - Pôles - Polzahl 1/2



Pitch / Pas	10
Rated Voltage / Tensione nominale	500
Rated Current / Corrente nominale	13,5

Types of cables / Tipo cavi	0,5 ÷ 1,5 / 30 ÷ 14	0,5 ÷ 1 / 30 ÷ 14	0,5 ÷ 1 / 30 ÷ 14
Nominal cross section / Sezione nominale	mm AWG	mm AWG	mm AWG
Stripping length / Lunghezza spelatura	6	6	6
Torque / Coppia di torsione	0,4	/	3
Temperature / Temperatura	85	85	85
Housing / Corpo isolante	PC - UL 94 V0		
Screw / Vite	M2,5		
Dimensions	0,6 x 3,5		

V	A	mm / AWG
750	13,5	0,5 ÷ 1
750	13,5	0,5 ÷ 1
300	14	26 ÷ 14

min 2 - max...		
GR	/ on demand	NE
D/A2		

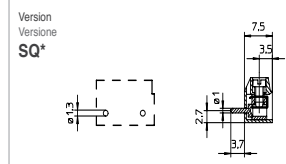
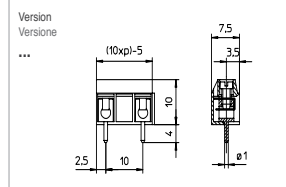

**CZI CZI..SQ\***

Single block - Blocco unico  
Monobloc - Einzelblock

Poles - Poli - Pôles - Polzahl 2/24



Pitch / Pas	5
Rated Voltage / Tensione nominale	200
Rated Current / Corrente nominale	13,5

Types of cables / Tipo cavi	0,5 ÷ 1,5 / 30 ÷ 14	0,5 ÷ 1 / 30 ÷ 14	0,5 ÷ 1 / 30 ÷ 14
Nominal cross section / Sezione nominale	mm AWG	mm AWG	mm AWG
Stripping length / Lunghezza spelatura	6	6	6
Torque / Coppia di torsione	0,4	/	3
Temperature / Temperatura	85	85	85
Housing / Corpo isolante	PC - UL 94 V0		
Screw / Vite	M2,5		
Dimensions	0,6 x 3,5		

V	A	mm / AWG
250	13,5	0,5 ÷ 1
250	13,5	0,5 ÷ 1
300	14	26 ÷ 14

min 2 - max 24		
GR	/ on demand	NE
D/A2		

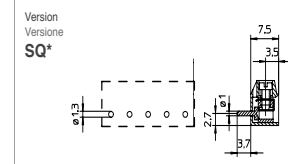
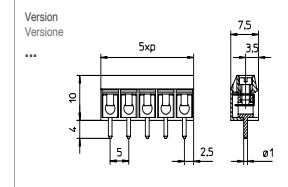

**CZI CZI..SQ\***

Single block - Blocco unico  
Monobloc - Einzelblock

Poles - Poli - Pôles - Polzahl 1/2



Pitch / Pas	10
Rated Voltage / Tensione nominale	500
Rated Current / Corrente nominale	13,5

Types of cables / Tipo cavi	0,5 ÷ 1,5 / 30 ÷ 14	0,5 ÷ 1 / 30 ÷ 14	0,5 ÷ 1 / 30 ÷ 14
Nominal cross section / Sezione nominale	mm AWG	mm AWG	mm AWG
Stripping length / Lunghezza spelatura	6	6	6
Torque / Coppia di torsione	0,4	/	3
Temperature / Temperatura	85	85	85
Housing / Corpo isolante	PC - UL 94 V0		
Screw / Vite	M2,5		
Dimensions	0,6 x 3,5		

V	A	mm / AWG
750	13,5	0,5 ÷ 1
750	13,5	0,5 ÷ 1
300	14	26 ÷ 14

min 2 - max 12		
GR	/ on demand	NE
D/A2		

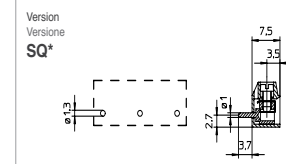
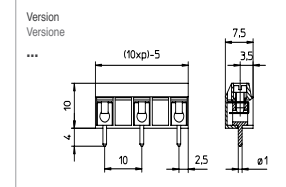

Pitch / Pas	5
Rated Voltage / Tensione nominale	200
Rated Current / Corrente nominale	13,5

Types of cables / Tipo cavi	0,5 ÷ 1,5 / 30 ÷ 14	0,5 ÷ 1 / 30 ÷ 14	0,5 ÷ 1 / 30 ÷ 14
Nominal cross section / Sezione nominale	mm AWG	mm AWG	mm AWG
Stripping length / Lunghezza spelatura	6	6	6
Torque / Coppia di torsione	0,4	/	3
Temperature / Temperatura	85	85	85
Housing / Corpo isolante	PC - UL 94 V0		
Screw / Vite	M2,5		
Dimensions	0,6 x 3,5		

V	A	mm / AWG
250	13,5	0,5 ÷ 1
250	13,5	0,5 ÷ 1
300	14	26 ÷ 14

min 2 - max...		
GR	/ on demand	NE
D/A2		

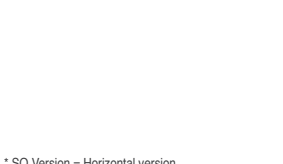
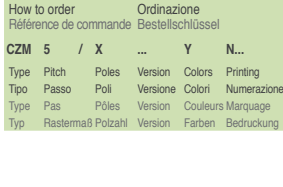

\* SQ Version = Horizontal version