

**CZM CZM..SQ\***

Interlocking modules - Modulo componibile  
Elements modulaires - Zusammensteckbare Blöcke

Poles - Poli - Pôles - Polzahl 2/3



Pitch / Passo / Rastermaß	5
Rated Voltage / Tensione nominale / Bemessungsspannung	200
Rated Current / Corrente nominale / Bemessungsstrom	13,5

Types of cables / Tipo cavi / Leitungstypen	0,5 ÷ 1,5 / 30 ÷ 14	0,5 ÷ 1 / 30 ÷ 14	0,5 ÷ 1 / 30 ÷ 14
Nominal cross section / Sezione nominale / Nennquerschnitt	mm AWG		
Stripping length / Lunghezza spelatura / Abisolierlänge	6		
Torque / Coppia di torsione / Drehmoment	0,4	/	3
Temperature / Temperatura / Temperatur	85		
Housing / Corps isolant / Isolierkörper	PC - UL 94 V0		
Screw / Vite / Schraube	M2,5		
	0,6 x 3,5		

V	A	mm / AWG
250	13,5	0,5 ÷ 1
250	13,5	0,5 ÷ 1
300	14	26 ÷ 14

min 2 - max...

GR / on demand NE

D/A2

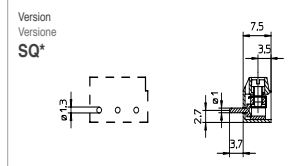
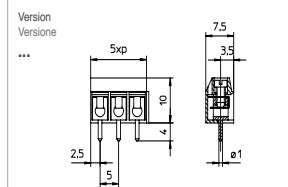

**CZM CZM..SQ\***

Interlocking modules - Modulo componibile  
Elements modulaires - Zusammensteckbare Blöcke

Poles - Poli - Pôles - Polzahl 1/2



Pitch / Passo / Rastermaß	10
Rated Voltage / Tensione nominale / Bemessungsspannung	500
Rated Current / Corrente nominale / Bemessungsstrom	13,5

Types of cables / Tipo cavi / Leitungstypen	0,5 ÷ 1,5 / 30 ÷ 14	0,5 ÷ 1 / 30 ÷ 14	0,5 ÷ 1 / 30 ÷ 14
Nominal cross section / Sezione nominale / Nennquerschnitt	mm AWG		
Stripping length / Lunghezza spelatura / Abisolierlänge	6		
Torque / Coppia di torsione / Drehmoment	0,4	/	3
Temperature / Temperatura / Temperatur	85		
Housing / Corps isolant / Isolierkörper	PC - UL 94 V0		
Screw / Vite / Schraube	M2,5		
	0,6 x 3,5		

V	A	mm / AWG
750	13,5	0,5 ÷ 1
750	13,5	0,5 ÷ 1
300	14	26 ÷ 14

min 2 - max...

GR / on demand NE

D/A2

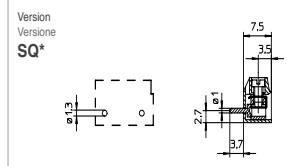
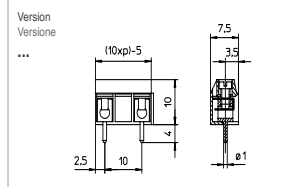

**CZI CZI..SQ\***

Single block - Blocco unico  
Monobloc - Einzelblock

Poles - Poli - Pôles - Polzahl 2/24



Pitch / Passo / Rastermaß	5
Rated Voltage / Tensione nominale / Bemessungsspannung	200
Rated Current / Corrente nominale / Bemessungsstrom	13,5

Types of cables / Tipo cavi / Leitungstypen	0,5 ÷ 1,5 / 30 ÷ 14	0,5 ÷ 1 / 30 ÷ 14	0,5 ÷ 1 / 30 ÷ 14
Nominal cross section / Sezione nominale / Nennquerschnitt	mm AWG		
Stripping length / Lunghezza spelatura / Abisolierlänge	6		
Torque / Coppia di torsione / Drehmoment	0,4	/	3
Temperature / Temperatura / Temperatur	85		
Housing / Corps isolant / Isolierkörper	PC - UL 94 V0		
Screw / Vite / Schraube	M2,5		
	0,6 x 3,5		

V	A	mm / AWG
250	13,5	0,5 ÷ 1
250	13,5	0,5 ÷ 1
300	14	26 ÷ 14

min 2 - max 24

GR / on demand NE

D/A2

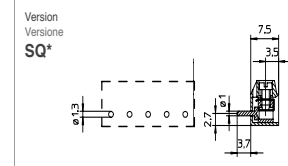
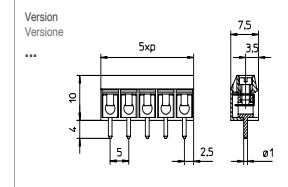

**CZI CZI..SQ\***

Single block - Blocco unico  
Monobloc - Einzelblock

Poles - Poli - Pôles - Polzahl 1/2



Pitch / Passo / Rastermaß	10
Rated Voltage / Tensione nominale / Bemessungsspannung	500
Rated Current / Corrente nominale / Bemessungsstrom	13,5

Types of cables / Tipo cavi / Leitungstypen	0,5 ÷ 1,5 / 30 ÷ 14	0,5 ÷ 1 / 30 ÷ 14	0,5 ÷ 1 / 30 ÷ 14
Nominal cross section / Sezione nominale / Nennquerschnitt	mm AWG		
Stripping length / Lunghezza spelatura / Abisolierlänge	6		
Torque / Coppia di torsione / Drehmoment	0,4	/	3
Temperature / Temperatura / Temperatur	85		
Housing / Corps isolant / Isolierkörper	PC - UL 94 V0		
Screw / Vite / Schraube	M2,5		
	0,6 x 3,5		

V	A	mm / AWG
750	13,5	0,5 ÷ 1
750	13,5	0,5 ÷ 1
300	14	26 ÷ 14

min 2 - max 12

GR / on demand NE

D/A2

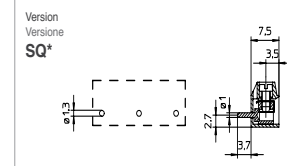
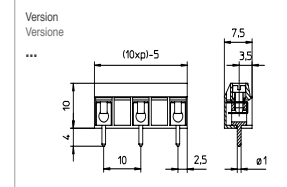

Pitch / Passo / Rastermaß	mm
Rated Voltage / Tensione nominale / Bemessungsspannung	V
Rated Current / Corrente nominale / Bemessungsstrom	A

Types of cables / Tipo cavi / Leitungstypen	0,5 ÷ 1,5 / 30 ÷ 14	0,5 ÷ 1 / 30 ÷ 14	0,5 ÷ 1 / 30 ÷ 14
Nominal cross section / Sezione nominale / Nennquerschnitt	mm AWG		
Stripping length / Lunghezza spelatura / Abisolierlänge	6		
Torque / Coppia di torsione / Drehmoment	0,4	/	3
Temperature / Temperatura / Temperatur	85		
Housing / Corps isolant / Isolierkörper	PC - UL 94 V0		
Screw / Vite / Schraube	M2,5		
	0,6 x 3,5		

IMQ	EN60998
VDE	EN60998
cUL	UL1059 + C22.2 n°158

min 2 - max...

GR / on demand NE

D/A2

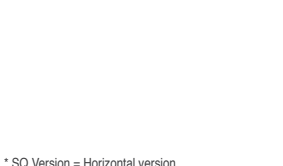
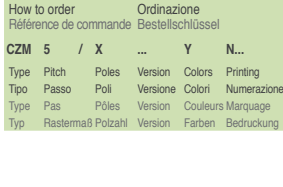

\* SQ Version = Horizontal version