

Pushbuttons and selector switches

PLatinum Ø22mm series

Accessories and spare parts



LPX A140



LPX B104



LPX B203



LPX BL105



LPX BL206

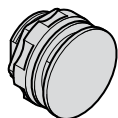

8 LM2T A130

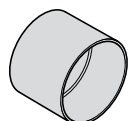

8 LM2T A185

Order code	Description	Qty per pkg	Wt
		n°	[kg]
LPX A127	Transparent diffuser for double-touch buttons	10	0.001
LPX A140	Action plug for centre contact	50	0.001
LPX A150	Rod for mechanical reset button (l=150mm/5.91in)	10	0.006
LPX A170	Spare standard key set for selector switches or mushroom-head buttons	10	0.008
LPX A170R ^①	Spare key set for selector switches or mushroom head buttons, LPC.. R type	1	0.008

Flush cap for spring-return actuators.

LPX B102	Black	10	0.002
LPX B103	Green	10	0.002
LPX B104	Red	10	0.002
LPX B105	Yellow	10	0.002
LPX B106	Blue	10	0.002
LPX B108	White	10	0.002

Extended cap for spring-return actuators.

LPX B202	Black	10	0.003
LPX B203	Green	10	0.003
LPX B204	Red	10	0.003
LPX B205	Yellow	10	0.003
LPX B206	Blue	10	0.003
LPX B208	White	10	0.003

Flush lens for illuminated spring-return actuators.

LPX BL103	Green	10	0.002
LPX BL104	Red	10	0.002
LPX BL105	Yellow	10	0.002
LPX BL106	Blue	10	0.002
LPX BL108	White	10	0.002

Extended lens for illuminated spring-return actuators.

LPX BL203	Green	10	0.003
LPX BL204	Red	10	0.003
LPX BL205	Yellow	10	0.003
LPX BL206	Blue	10	0.003
LPX BL208	White	10	0.003

^① Versions with different key code. Complete with the numeric code of the key. The following versions are available: 421E, 458A, 520E, 3131A, 3433E. Example of complete code: LPX A170R421E.

Order code	Description	Qty per pkg	Wt
		n°	[kg]
8 LM2T A130	Threaded plug for unused drilled holes	10	0.007
8 LM2T A161	Ø30mm/1.2in hole size adapter set for 22mm/0.87in (use 2 per hole)	10	0.002
8 LM2T A185	Selector protection shroud for knob type only	10	0.004
8 LM2T A200	Socket spanner/wrench for fixing ring fitting	1	0.184