

# Snap-In Panel Mount Hydraulic Magnetic Circuit Breaker

The NDB3-30 series is a compact, snap-in, panel mount circuit breaker family. They have been designed to be aesthetically pleasing on your piece of equipment. The rocker guard is meant to prevent accidental tripping by being brushed against. The NDB3-30 is available in single pole, 1 to 30 amps, and with short and medium delay AC or DC trip curves. The convenient snap in mounting eliminates the need for any additional mounting material. Housings are available in gray or black and the rockers in black, white or orange. The easy to read printing can be specified in either the vertical or horizontal position.



## Features:

- UL1077 Recognized
- Easy snap-in mounting
- Short and Medium trip curves
- 1 to 30 amp ratings
- Rocker guard standard
- Black, white or orange rockers
- Easy to read printing
- RoHs compliant

## Provide protection for:

- Power Supplies
- Office Equipment
- Medical Equipment
- Vending Machines
- Amusement Equipment
- Fitness Equipment
- Telecommunications

## DC Medium Delay Trip Curve

Rated Current (Amps)	Part Number
1	NDB3-30Z41-1QHY110R
2	NDB3-30Z42-1QHY110R
3	NDB3-30Z43-1QHY110R
4	NDB3-30Z44-1QHY110R
5	NDB3-30Z45-1QHY110R
6	NDB3-30Z46-1QHY110R
8	NDB3-30Z48-1QHY110R
10	NDB3-30Z410-1QHY110R
12	NDB3-30Z412-1QHY110R
15	NDB3-30Z415-1QHY110R
16	NDB3-30Z416-1QHY110R
20	NDB3-30Z420-1QHY110R
24	NDB3-30Z424-1QHY110R
25	NDB3-30Z425-1QHY110R
30	NDB3-30Z430-1QHY110R

## AC Medium Delay Trip Curve

Rated Current (Amps)	Part Number
1	NDB3-30J41-1QHY110R
2	NDB3-30J42-1QHY110R
3	NDB3-30J43-1QHY110R
4	NDB3-30J44-1QHY110R
5	NDB3-30J45-1QHY110R
6	NDB3-30J46-1QHY110R
8	NDB3-30J48-1QHY110R
10	NDB3-30J410-1QHY110R
12	NDB3-30J412-1QHY110R
15	NDB3-30J415-1QHY110R
16	NDB3-30J416-1QHY110R
20	NDB3-30J420-1QHY110R
24	NDB3-30J424-1QHY110R
25	NDB3-30J425-1QHY110R
30	NDB3-30J430-1QHY110R

\*Other amperage available upon request

## Specifications

Number of Poles: 1  
 Rated Voltage: AC 250V, DC 80V  
 Min. Amp Rating: 1A  
 Max. Amp Rating: 30A  
 Interrupting Capacity: 1.0kA  
 Mechanical Life: 10,000 Operations  
 Operating Temp. Range: -40°C - 85°C  
 Agency Approvals: UL1077, CE, & TUV

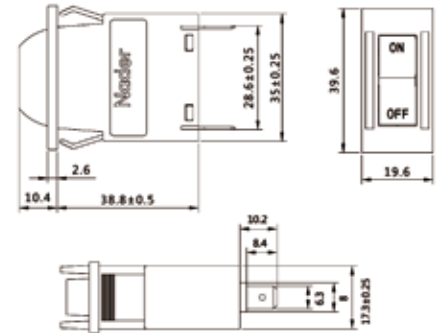

AC/DC Short delay  
(Upon Request)

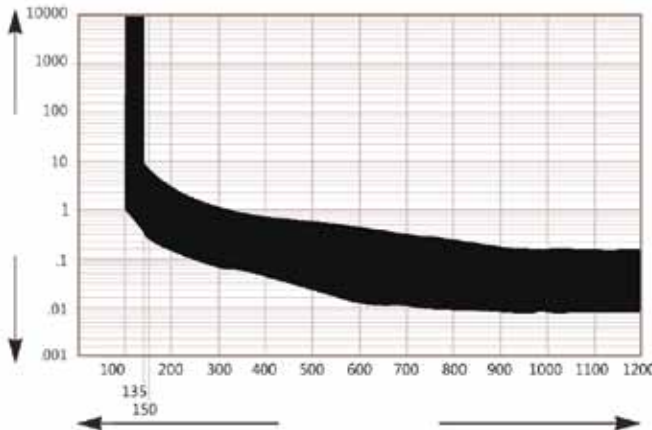

AC/DC Medium delay

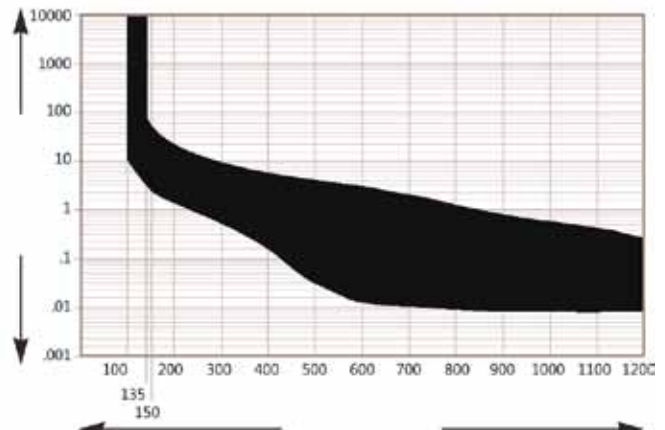

Visit [www.asi-ez.com](http://www.asi-ez.com)