

1880  
1890



### Concentric sealing rings *Material: BUTADIENE-NITRILE NBR with concentric perforations*

Ref.	Suitable only for Cable Glands PG4 (1700... 2002...)	Ø E (mm)	Ø 3 (mm)	Ø 2 (mm)	Ø 1 (mm)	Ø 1 (mm)	H (mm)	Quantity Box/Bag
1880	Pg9	13,3	-	10	7,5	5	5,5	1.500/100
1881	Pg11	16,5	-	12,5	10	7,5	6	1.000/100
1882	Pg13,5	18,3	-	12,5	10	7,5	6	800/100
1883	Pg16	20,4	15	12,5	10	7,5	7	600/100
1884	Pg21	25,9	19	16	13	10	8	300/100
*1885	Pg29	34,7	27	24	21	18	9,5	150/50
1886	Pg36	44,7	33	30	27	24	12	100/50
*1887	Pg42	51,7	39	36	33	30	14	50/25
*1888	Pg48	56,9	45	42	39	36	14	50/25

\*Dimensions DIN 46 320-7; material: CHLOROPRENE

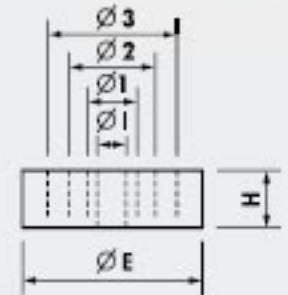

### O-rings

*Material: Butadiene-Nitrile 70 sh*

Ref.	Fits thread	Ø E (mm)	Ø I (mm)	H (mm)	Quantity Box/Bag
1889	M12	12,81	9,25	1,78	1.000
1890	Pg7 + G1/4"	14,38	10,82	1,78	5.000/1.000
1890A	M16 + Pg9 + G3/8"	15,98	12,42	1,78	5.000/1.000
1891	Pg11	19,16	15,60	1,78	5.000/1.000
1891A	M20	20,73	17,17	1,78	5.000/1.000
1892	Pg13,5 + G1/2"	22,33	18,77	1,78	5.000/1.000
1892A	Pg16 + G5/8"	23,91	20,35	1,78	5.000/1.000
1892B	M25	25,51	21,95	1,78	5.000/1.000
1893	Pg21	28,68	25,12	1,78	3.000/500
1893A	M32	30,00	26,00	2,00	500
1925,3	G3/4"	30,31	25,07	2,62	1.000/500
1894	G1"	35,06	29,82	2,62	1.000/500
1895	M40 + Pg29 + G1 1/8"	39,84	34,60	2,62	1.000/500
1896	G1 1/4"	43,01	37,77	2,62	500
1897	Pg36 + G1 1/2"	49,35	44,12	2,62	800/100
1898	Pg42 + G1 3/4"	55,71	50,47	2,62	800/100
1899	Pg48 + G2"	62,06	56,82	2,62	100
1899A	G2 1/2"	76,50	69,44	3,53	100/1
1899B	G3"	92,60	81,92	5,34	100/1

